

Series 18 compact medium duty stage track technical data sheet

S18-3441 rev 1

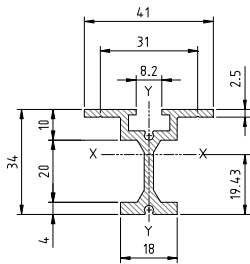

track section 3441

area	288mm ²
lxx	43029mm ⁴
lyy	18927mm ⁴
rx	12.216mm
ry	8.102mm
material	aluminium 6060 T5
0.2% proof	110MPa
UTS	150MPa
Mass	0.778kg/m (4.67kg/6m)
finish	black anodised 15µm

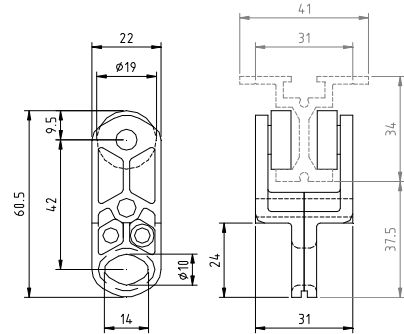

recommended support centres 1.0m (1.5m max.).

runner

registered design AU 156591

body material	glass reinforced nylon - black
wheels	ball bearing, acetal tyre -black
capacity	12kg @ 0.5 m/s
mass	28g

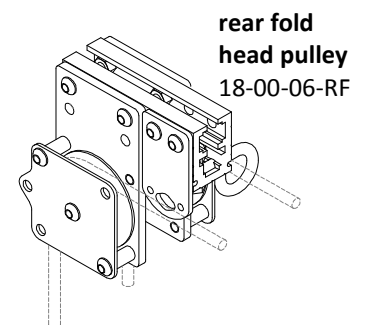
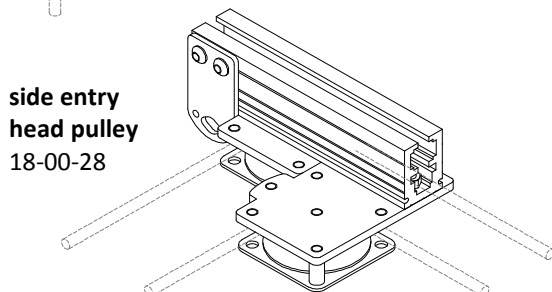
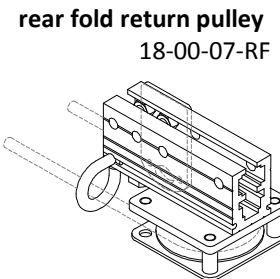
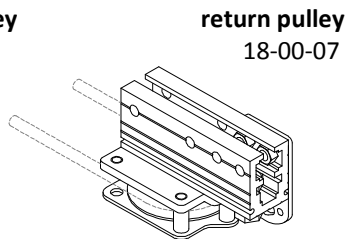
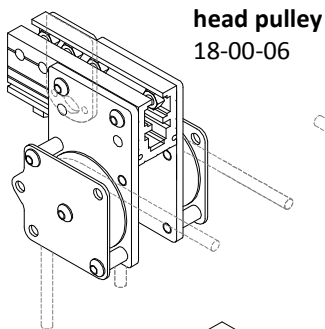
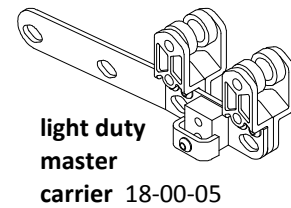
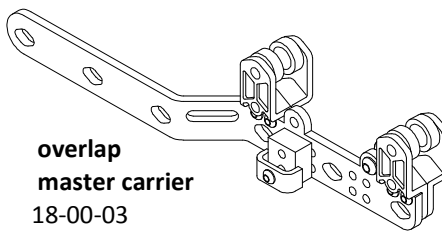
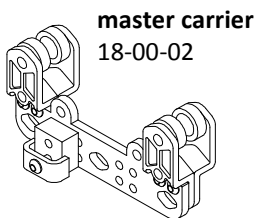
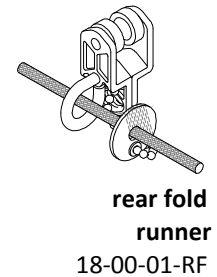
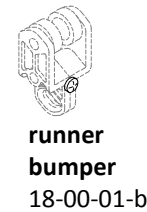
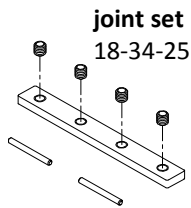
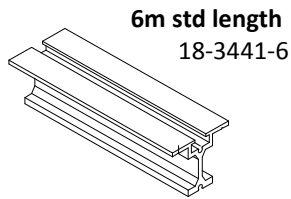

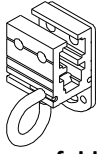

rear fold end stop
18-00-18-RF

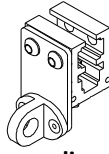

line guide
18-00-19

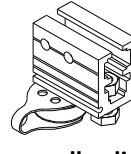

pulley line guide
18-00-20

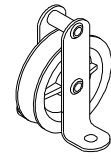

plain floor pulley
18-00-14

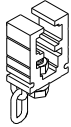

compact end stop
18-00-23

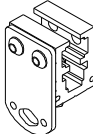

end stop -eye
18-00-18

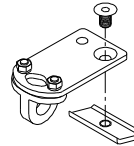

outrigger guide
18-34-26

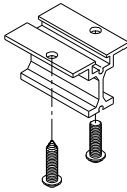

drill holes for batten / soffit fixing



eyebolt hanger assembly

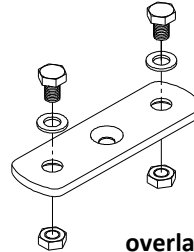

overlap clip
18-00-27

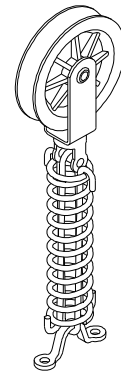

spring loaded floor pulley
18-00-16

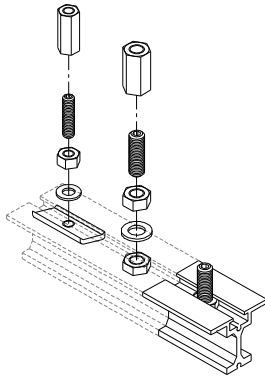

threaded rod / socket hanger assemblies

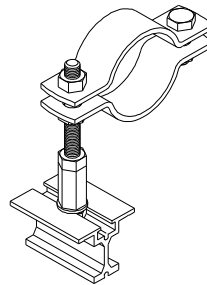

batten clip & threaded rod dropper

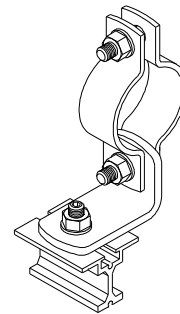

batten clip & angle bracket
18-00-36